

Bone Conduction Wireless Headset (BTS19)

VALORE

Thank you for purchasing the Valore Bone Conduction Wireless Headset (BTS19).

Enjoy an amazing music experience with advanced bone conduction technology that delivers music through your cheekbones – all while ensuring your ears remain completely open to ambient sound. Plus, stay connected on the go with the headset's talk function. A perfect companion for the music and sports lover in you.

Important: Please read the user manual thoroughly before using your wireless headset.

Specifications:

- Wireless range: Up to 10m
- Battery type: 200mAh Lithium battery
- Charging time: Up to 2 hours
- Playback time: Up to 6 hours
- Standby time: Up to 120 hours
- Power input: DC5V/200mA
- Dimension (L x W x D): 145 x 119 x 54mm
- Material: ABS + PC
- Weight: 49g

Package Contents:

- Bone conduction wireless headset
- Micro USB charging cable (300mm)

UNDERSTANDING THE PRODUCT

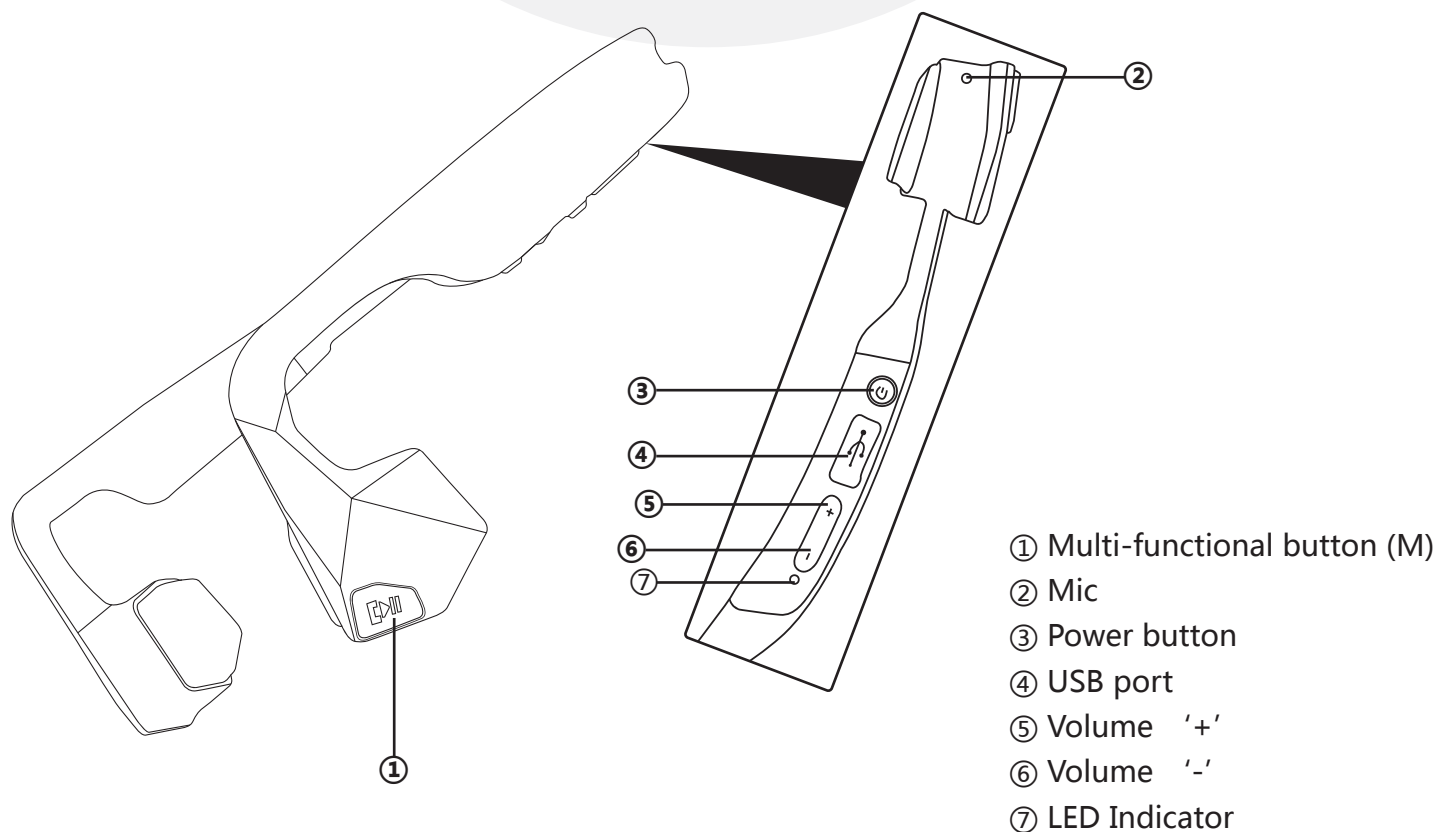

START USING THE WIRELESS HEADSET

1) Charging the wireless headset

Connect the USB charging cable to the headset located on the side of the left side.

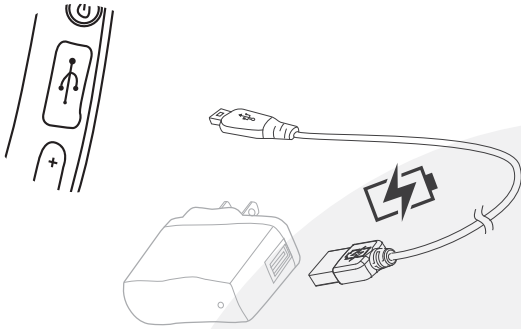

Note: Please charge the headset for at least 8 hours before first use. Please make sure that the headset is switched off when charging is in progress.

COLOR	STATUS	MEANING
Red	Blinking	Low battery
Red	Solid	Charging/Connected
Blue	Solid	Charging complete
Red & Blue	Altering blinks	Pairing
Blue	Single blink every 5 seconds	Successfully paired
Blue	Double blink every 2 seconds	Unpaired/Stand-by
Violet	Last 1 seconds	Power-off/Power-on

2) Pairing the wireless headset (switched off)

Step 1: Activate Bluetooth function on your mobile device to begin pairing with headset.

Step 2: Press and hold onto the Power button located on the left side of the headset until the LED light flickers red and blue.

Step 3: Connect to the headset by selecting 'Valore BTS19' under the device list.



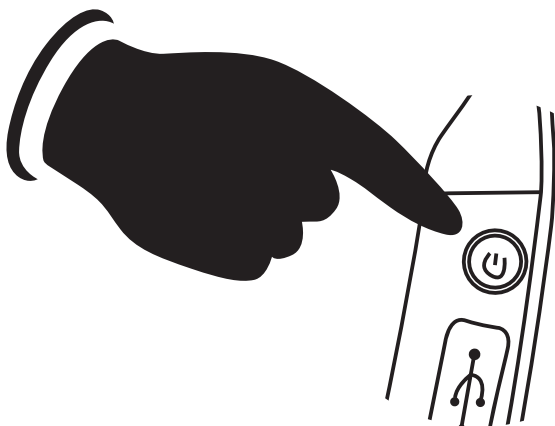

Step 4: Once connected, the LED light at the Bluetooth button will blink blue in interval of 5 seconds.



Note: If the pairing is not successful, please turn off wireless headset first, and then re-pair again. After pairing is successful, paired devices will remember each other. Unless pairing information is deleted because of new pairing, no need to pair when using the next time.





If you want to pair the wireless headset with other devices, please turn off Bluetooth function of existing source device, and pair the wireless headset with the new device according to steps 1-4 mentioned above.

3) Wireless headset controls

BASIC FUNCTION		
FUNCTION	OPERATION	SIGNAL/PROMPT
Power on	Hold the Power Button for 4 seconds	1 second blue light; Audio
Power off (Manually)	Hold the Power Button for 4 seconds	1 second blue light; Audio
Power off (Automatically)	Stand by for 10 minutes/ Battery voltage below 2.7V	
Pairing	Hold the Power Button for  6 seconds	Altering blue & red blinks; Audio
	Hold the Multifunction button for 6 seconds 	
Connected		Single blue blink every 5 seconds; Audio
Reconnect (Manually)	Quick press the Multifunction  button	
Enter the music player mode	Double click power button 	Double green blinks every 2 seconds

MUSIC FUNCTION		
FUNCTION	OPERATION	SIGNAL/PROMPT
Play/Pause	Press the button 	Audio
Previous/Next	Hold “-” / “+” for 2 seconds	Audio
Volume up/down	Press the “+” / “-” button	Audio (At max level)

NOTICE Some player software or devices may cause the earphone "play/pause, previous/next" functions fail, then please operate the buttons on device or software to control.

BASIC FUNCTION		
FUNCTION	OPERATION	SIGNAL/PROMPT
Answer/End	Press the button 	Audio
Reject	Hold the button for  2 seconds	Audio
Redial	Quickly double click the  button	Audio
Earphone/ Phone Switch	During phone call, hold the button for 2seconds 	Audio
Volume up/down	Press the “+” / “-” button	Audio(At max level)

4) How to wear

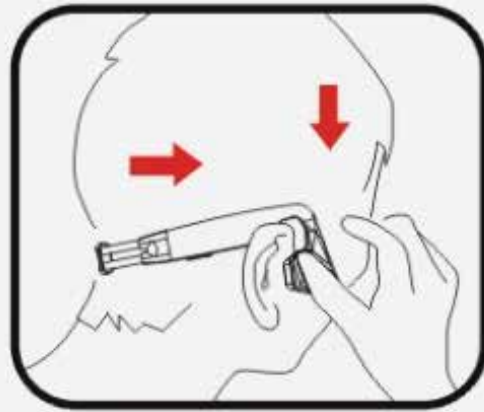
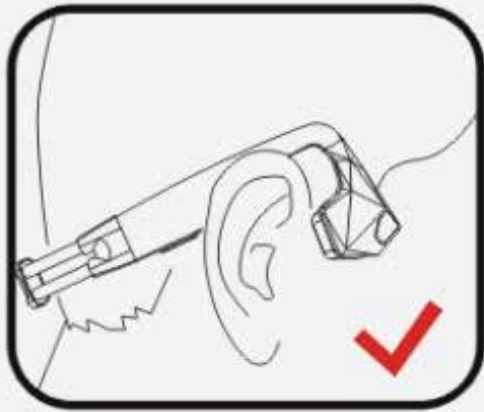
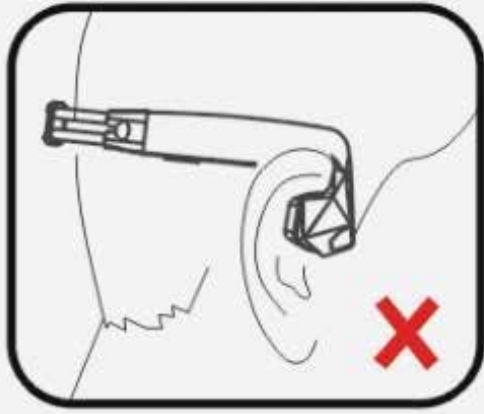

TROUBLESHOOTING

Issue 1: headset is unable to connect successfully to your mobile device

Problem 1: Headset's battery is flat

Solution: Fully charge the headset (2.5 hours) and retry connection with your mobile device.

Problem 2: Headset not paired to your mobile device

Solution: Make sure that the headset is successfully paired upon selecting 'Valore BTS-19' in the device list.

Problem 3: Headset and mobile device too far apart

Solution: Make sure that the headset is within a metre range during pairing and connection.

Problem 4: Headset is connected to other mobile device

Solution: Make sure that the headset has already been disconnected before making a new connection with a new device.

Issue 2: Sound from the headset is too soft or silent

Problem 1: Headset's battery is low / flat

Solution: Fully charge the headset (2.5 hours) and retry connection with your mobile device.

Problem 2: Headset or mobile device's volume is too low

Solution: Turn the volume of the headset or mobile device up to increase the volume.

Problem 3: Music track may not be audible

Solution: Make sure that the music track is of a playable format for the mobile device.

Problem 4: Headset and mobile device might not be connected properly.

Solution: Repeat the connection step via Bluetooth/auxiliary cable again to make sure that it is connected properly and try again.

TECHNICAL SUPPORT & WARRANTY

- For Technical Support, email us at v.info@valore.sg.
- For Warranty Registration, visit www.valore.sg.

Cautions:

Read all the instructions and warnings carefully prior to using this product.

- Do not store the headset in a high temperature environment.
- Do not place the headset near a fire or other excessively hot environments.
- Do not expose this headset to moisture or submerge it in liquid. Keep headset dry at all times.
- Do not attempt to charge the headset using any other method or connection other than the headset's provided charging cable.
- Do not disassemble this headset or attempt to repair or modify it in any manner.
- Be cautious of excessive drops, bumps, abrasions or other impacts to this headset. If there is any damage to the headset such as dents, punctures, tears, deformities or corrosion, stop using the headset and contact us immediately via email at v.info@valore.sg, or return this product to the store where you have purchased it from.
- If the product produces an abnormal smell, high temperature (low temperature during normal use), discolours or changes shape abnormally, stop using the product and contact us immediately via email at v.info@valore.sg.

DISCLAIMER & TRADEMARKS

All information, trademarks, logos, graphics, and images ("Materials") provided on this user manual are copyrighted or trademarked and are the property of Valore Lifestyle Pte Ltd. Any unauthorized use of any material contained on the instruction manual may violate copyright laws, trademark laws, laws of privacy and communications statutes.

The trademarks, service marks and logos used and displayed in the Materials are registered and unregistered trademarks and service marks of Valore and others. All other registered and unregistered company names, product names and marks mentioned herein the ("Materials") are the property of their respective owners and may be trademarks or registered trademarks.

Complies with
IMDA Standards
DA103331



Inspired by Valore Singapore

For full range of Valore products visit www.valore.sg