

Wireless Speaker With Wireless Charging Pad (BTS27)

VALORE

Thank you for purchasing the Valore Wireless Speaker With Wireless Charging Pad (BTS27).

- Built-in microphone enables hands-free usage
- Wirelessly charge any Qi-enabled device while listening to high quality music
- Power-saving mode switches off speaker when left idle for 10 minutes

Important: Please read the user manual thoroughly before using your wireless speaker.

Specifications:

- Wireless range: Up to 10m
- Built-in battery: 4000mAh Lithium battery
- Standby Time: Up to 200 hours
- Charging time: Approximately 4 hours
- Playback/working time: Up to 9 hours
- Power input: DC5V/1A
- Power output: 5W
- Wireless charging power output: 5W
- Support: microSD™ card (not included)

Package Contents:

- Wireless speaker with wireless charging pad
- USB charging cable (600mm)

UNDERSTANDING THE PRODUCT

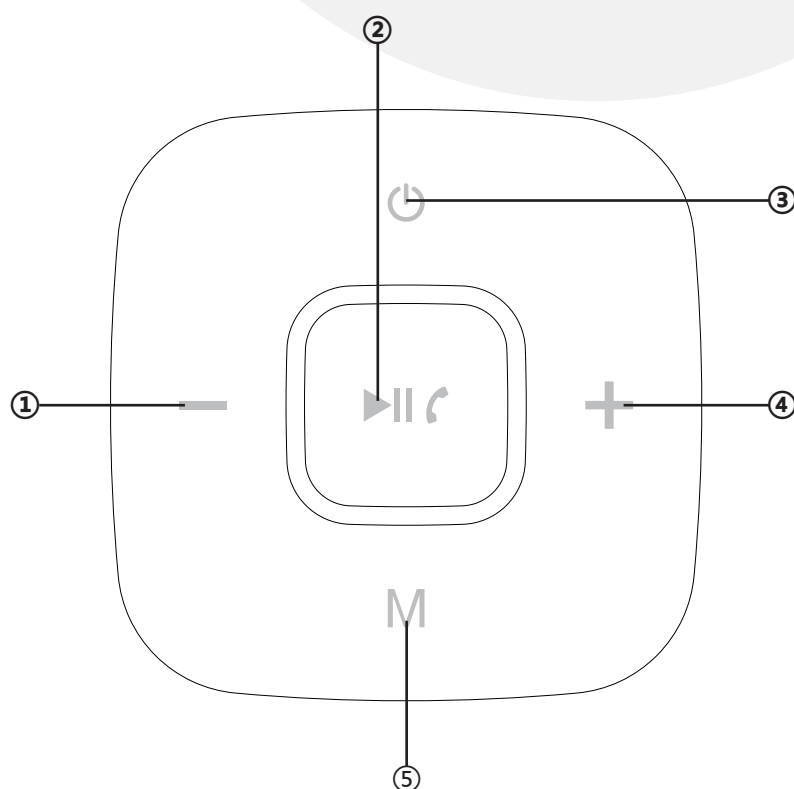

- ① Previous track/Volume down
- ② Play/Pause/Answer call
- ③ On/Off
- ④ Next track/Volume Up
- ⑤ Switch mode

START USING THE WIRELESS SPEAKER

Charging the wireless speaker

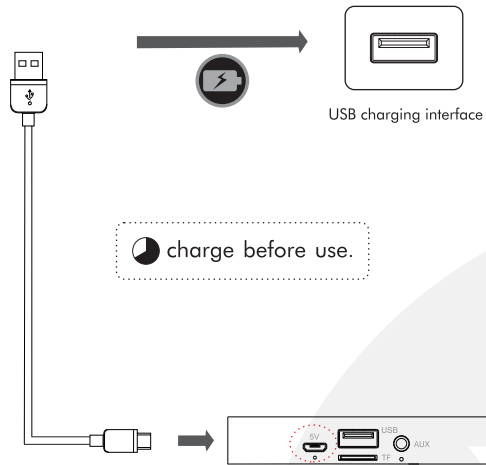

Power On (Long press)

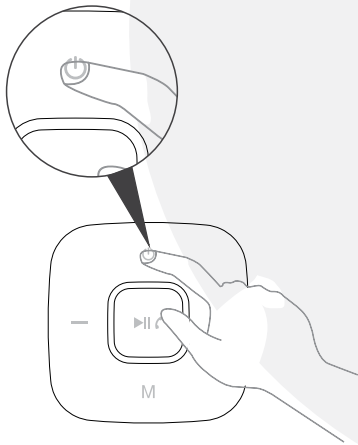

Pairing the wireless speaker (switched off)

Step 1: Activate Bluetooth function on your mobile device to begin pairing with speaker.

Step 2: Switch on speaker by long pressing the On/Off button.

Step 3: Connect to the speaker by selecting 'Valore BTS27' under the device list.

Note: If the pairing is not successful, please turn off wireless speaker first, and then re-pair again. After pairing is successful, paired devices will remember each other. Unless pairing information is deleted because of new pairing, no need to pair when using the next time.

If you want to pair the wireless speaker with other devices, please turn off Bluetooth function of existing source device, and pair the wireless speaker with the new device according to steps 1-3 mentioned above.

Conecting to audio devices

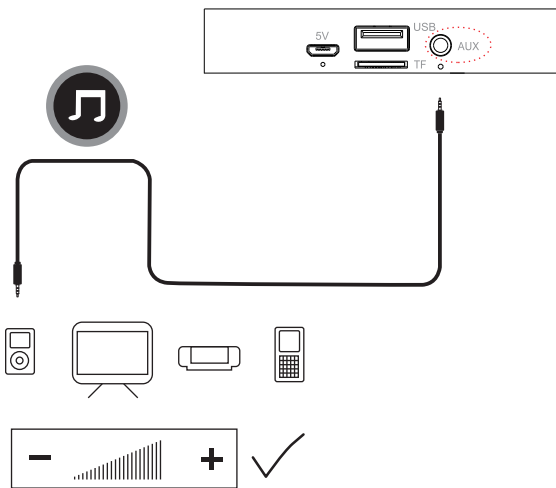

USB & Micro USB slot

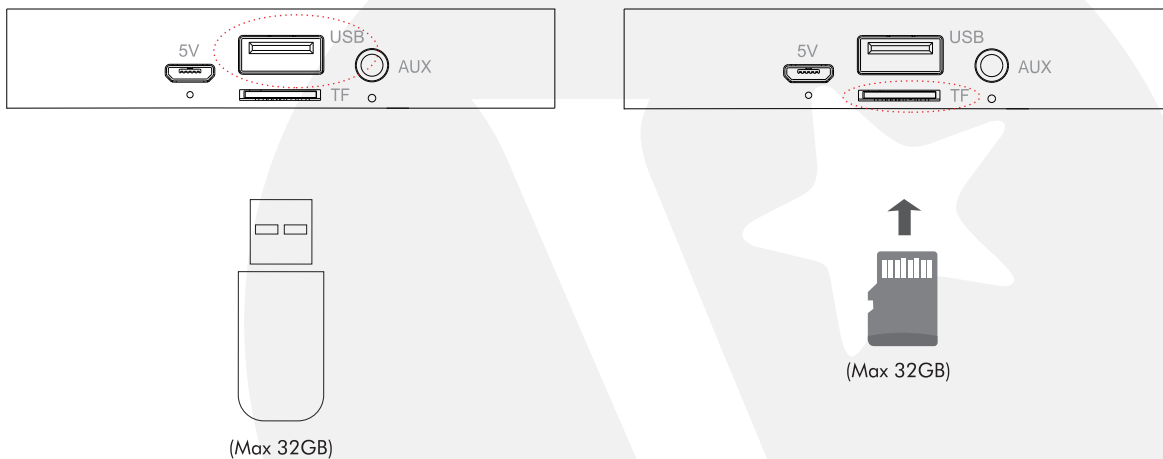

TWS (True Wireless Stereo) Function:

to pair one mobile phone with 2 speakers together

1. Make sure to have 2 BTS27 speakers, turn on both speakers together and LED shows quick flash, press and hold Play/Pause/Answer call button of either one for about 5 seconds, both speakers will go into TWS pairing mode to pair with each other first.
2. Hearing sound "beep", and LED turns to slow flash which means both speakers paired with each other successful.
3. Then, activate Bluetooth function of your device and pair with Bluetooth name Valore BTS27. You would enjoy music in True Wireless Stereo sound from two speakers simultaneously.

TROUBLESHOOTING

Issue 1: Speaker is unable to connect successfully to your mobile device

Problem 1: Speaker's battery is flat

Solution: Fully charge the speaker (4 hours) and retry connection with your mobile device.

Problem 2: Speaker not paired to your mobile device

Solution: Make sure that the speaker is successfully paired upon selecting 'Valore BTS27' in the device list.

Problem 3: Speaker and mobile device too far apart

Solution: Make sure that the speaker is within a metre range during pairing and connection.

Problem 4: Speaker is connected to other mobile device

Solution: Make sure that the speaker has already been disconnected before making a new connection with a new device.

Issue 2: Sound from the speaker is too soft or silent

Problem 1: Speaker's battery is low / flat

Solution: Fully charge the speaker (4 hours) and retry connection with your mobile device.

Problem 2: Speaker or mobile device's volume is too low

Solution: Turn the volume of the speaker or mobile device up to increase the volume.

Problem 3: Music track may not be audible

Solution: Make sure that the music track is of a playable format for the mobile device.

Problem 4: Speaker and mobile device might not be connected properly.

Solution: Repeat the connection step via Bluetooth again to make sure that it is connected properly and try again.

TECHNICAL SUPPORT & WARRANTY

- For Technical Support, email us at v.info@valore.sg.
- For Warranty Registration, visit www.valore.sg.

Cautions:

Read all the instructions and warnings carefully prior to using this product.

- Do not store the speaker in a high temperature environment.
- Do not place the speaker near a fire or other excessively hot environments.
- Do not expose this speaker to moisture or submerge it in liquid. Keep speaker dry at all times.
- Do not attempt to charge the speaker using any other method or connection other than the headset's provided charging cable.
- Do not disassemble this speaker or attempt to repair or modify it in any manner.
- Be cautious of excessive drops, bumps, abrasions or other impacts to this headset. If there is any damage to the speaker such as dents, punctures, tears, deformities or corrosion, stop using the speaker and contact us immediately via email at v.info@valore.sg, or return this product to the store where you have purchased it from.
- If the product produces an abnormal smell, high temperature (low temperature during normal use), discolours or changes shape abnormally, stop using the product and contact us immediately via email at v.info@valore.sg.

DISCLAIMER & TRADEMARKS

All information, trademarks, logos, graphics, and images ("Materials") provided on this user manual are copyrighted or trademarked and are the property of Valore Lifestyle Pte Ltd. Any unauthorized use of any material contained on the instruction manual may violate copyright laws, trademark laws, laws of privacy and communications statutes.

The trademarks, service marks and logos used and displayed in the Materials are registered and unregistered trademarks and service marks of Valore and others. All other registered and unregistered company names, product names and marks mentioned herein the ("Materials") are the property of their respective owners and may be trademarks or registered trademarks.

Complies with
IMDA Standards
DA103331



Inspired by Valore Singapore

For full range of Valore products visit www.valore.sg