

# Valore Smartfly- Mini Drone with WiFi Camera (V-LA09)

# VALORE

Thank you for purchasing the Valore Smartfly - Mini Drone with WiFi Camera.

With exceptional flight stability, you can now discover the world with the Valore Smartfly. Capture superior footage while enjoying a smooth piloting experience with the touch of your smartphone/tablet screen.

**Important:** Please read the user manual thoroughly before using your Mini Drone.

## Specifications:

- Wireless range: Up to 50m
- Maximum speed: 2m/s
- Video resolution: 480P
- Battery type: 3.7V 300mAh polymer battery
- Material: ABS + PC
- Dimensions (H x W x D): 130 x 130 x 30mm
- Weight: 200g

## Package Contents:

- Mini drone with WiFi camera
- USB charging cable
- Blade x 8

## UNDERSTANDING THE PRODUCT



- ① On/Off connector
- ② Micro SD card slot
- ③ Blade
- ④ Battery
- ⑤ Protecting frame

# START USING MINI DRONE

## 1) Charging the battery

a) Insert battery plug into charger and charging cable provided to a charging adaptor or PC. When the battery is fully charge, the red light on the charger will go off.

Note: Average charging time is approx. 35 minutes. The mini drone operates for approx. 6-8 minutes.

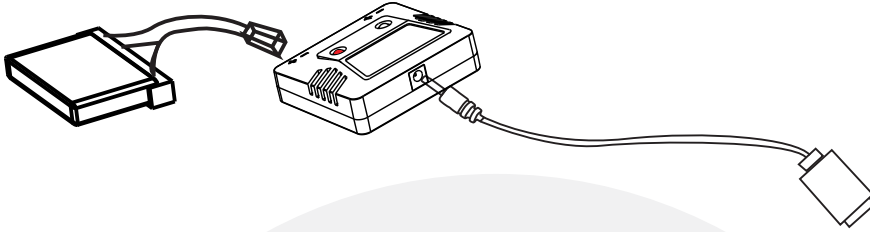

## 2) Switching On/Off

a) Switch on the mini drone by connecting the On/Off connector located at the back of the mini drone.

## 3) Pairing your device to the mini drone

For Android, download the app 'GD\_WiFi\_RC\_1.0.3' from Google Play.  
For iOS, download the app 'GD\_WiFi\_RC2' from the App Store.

- Switch on the mini drone by connecting the On/Off connector. The indicator on the mini drone will be flashing.
- Switch on the WiFi on your device and connect to "SmartFly".
- Launch the respective app (GD\_WiFi\_RC) on your device. The indicator on the mini drone will stop flashing.
- Touch 'Control', the phone screen is in the real time image and video state.
- Push engine (located on the left) up and down to make the drone match code with device, then you can start to control the drone.

## 4) Mobile control keys

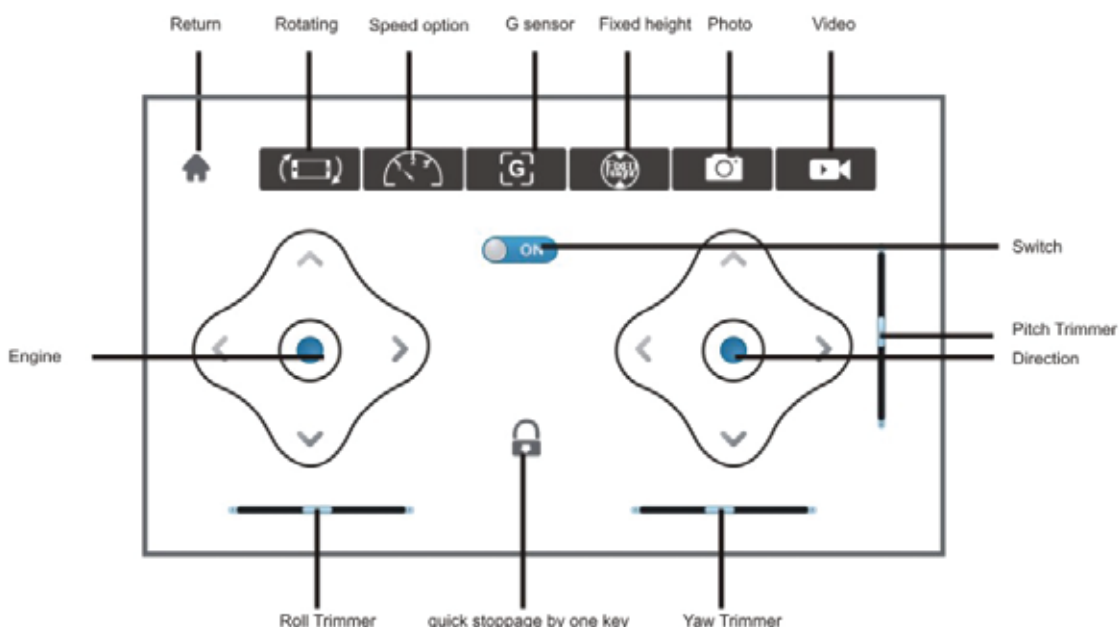

Practice these basic controls before flying your drone.

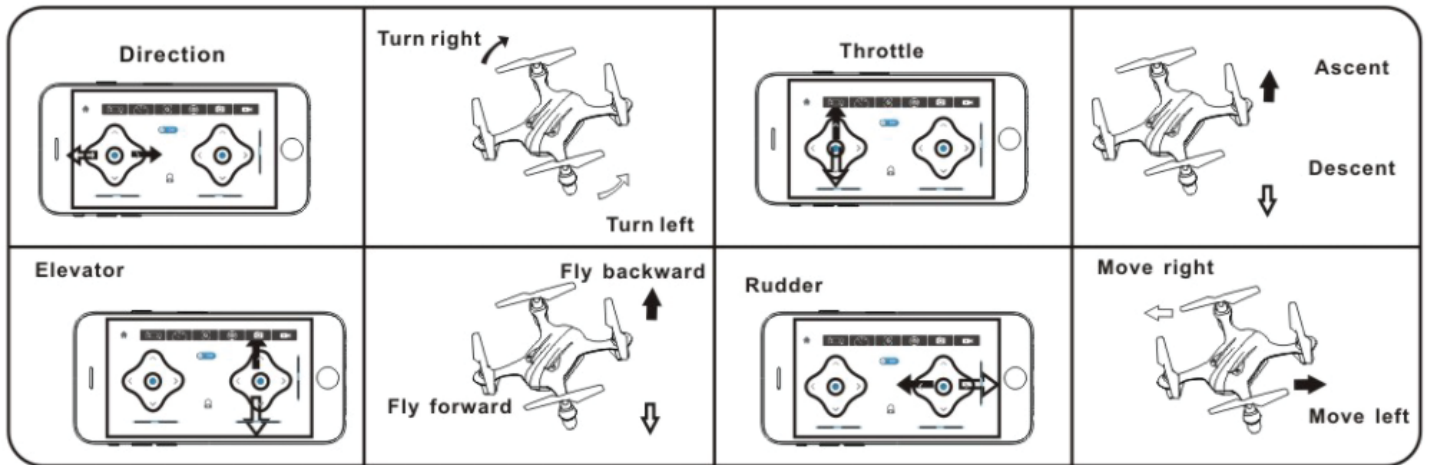

### Trottle Control Practice

Practice ascending and descending by pushing the control up to the middle, when it fly to the height of your eye line, push the control down to slowly land the mini drone on the floor.

### Direction Control Practice

Practice forward and back by pushing the control left and right, keeping a certain height steadily.

### Adjustment Of Each Trim

Slowly raise the trottle stick and just as the mini drone is off the ground, you can use the trim to correct the action if it leans in a different direction.

a) Adjustment of Left/Right trim -

When it leans right, adjust the trim to the left side. When it leans left, adjust the trim to the right side.

b) Adjustment of Forward/Backward trim -

When it leans forward, adjust the trim down. When i leans backwards, adjust the trim up.

c) Adjust the Crab trim -

When it crab right, adjust the trim to left. When it crab left, adjust the trim to right.

### 5) Camera/Video function

Take a photo: Touch the camera button. The photo will be taken when the tail of the mini drone flash once.

Take a video: Touch the video button. The video will start recording when the tail of the mini drone flashes slowly. Touch video button again to stop recording.

## 5) Replacing the propeller blade

When replacing the propeller blades, make sure to match both the colour of the blades and the letter indicated at the bottom of the blade.

Grey Blade Front (Left)= F  
Grey Blade Front (Right)= R

Black Blade Back (Left)= R  
Black Blade Back (Right)= F

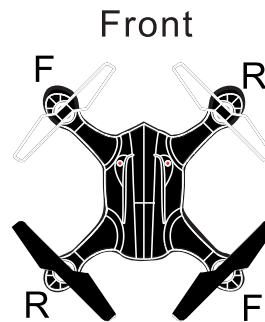

## Trouble Shooting During Flight

### Situation:

After connecting battery to the mini drone, the LED indicators keep flashing and does not respond to operations.

### Cause:

a) Unable to pair mini drone to mobile.

### Solution:

a) Connect the mobile to mini drone via WiFi under "SmartFly".

### Situation:

No response after battery is connected to mini drone.

### Cause:

a) Poor contact on battery terminals.

### Solution:

- a) Ensure mini drone battery is inserted properly.
- b) Use fully charged batteries
- c) Ensure battery is properly connected to mini drone.

### Situation:

Mini drone does not respond to throttle stick, receiver LED flashes.

### Cause:

a) Mini drone battery low.

### Solution:

a) Fully charge the battery or replace with a fully charged battery.

### Situation:

Blade spins but unable to take off.

### Cause:

a) Damaged blades

### Solution:

a) Replace damaged blades.

## TECHNICAL SUPPORT & WARRANTY

- For Technical Support, email us at [v.info@valore.sg](mailto:v.info@valore.sg).
- For Warranty Registration, visit [www.valore.sg](http://www.valore.sg).

### Cautions:

Read all the instructions and warnings carefully prior to using this product.

- Do not store the mini drone in a high temperature environment.
- Do not place the mini drone near a fire or other excessively hot environments.
- Do not expose this mini drone to moisture or submerge it in liquid. Keep mini drone dry at all times.
- Do not disassemble this mini drone or attempt to repair or modify it in any manner.
- Be cautious of excessive drops, bumps, abrasions or other impacts to this mini drone. If there is any damage to the mini drone such as dents, punctures, tears, deformities or corrosion, stop using the mini drone and contact us immediately via email at [v.info@valore.sg](mailto:v.info@valore.sg), or return this product to the store where you have purchased it from.
- If the product produces an abnormal smell, high temperature (low temperature during normal use), discolours or changes shape abnormally, stop using the product and contact us immediately via email at [v.info@valore.sg](mailto:v.info@valore.sg).

### DISCLAIMER & TRADEMARKS

All information, trademarks, logos, graphics, and images (“Materials”) provided on this user manual are copyrighted or trademarked and are the property of Valore Lifestyle Pte Ltd. Any unauthorized use of any material contained on the instruction manual may violate copyright laws, trademark laws, laws of privacy and communications statutes.

The trademarks, service marks and logos used and displayed in the Materials are registered and unregistered trademarks and service marks of Valore and others. All other registered and unregistered company names, product names and marks mentioned herein the (“Materials”) are the property of their respective owners and may be trademarks or registered trademarks.

Complies with  
IDA standards  
DA 103331



Inspired by Valore Singapore

For full range of Valore products visit [www.valore.sg](http://www.valore.sg)